

General Notes

Assembly Overview.-Attach two 4x8 Wagons Together with Carriage Bolts
 -Build Like a Platform Vertically
 -Cut Lumber
 -Pre-Drill & Assemble with (3) 3" Screws per Joint
 -Add extra Short 2x4
 -Screw in Bar
 -Screw in Facing on One Side
 -Bolt/Lag to Wagons
 -Screw in Back Facing



1 Overview
 Scale: 1/2" = 1'-0"

Show Name Catch Me If YouCan		
Scale 1/2"=1'	Drawn By Scott Bedell	Date 3/12/2019
Scene: Bar	Object Overview	Page Number 1

1 **Front**
Scale: 1/2" = 1'-0"

16'-0"

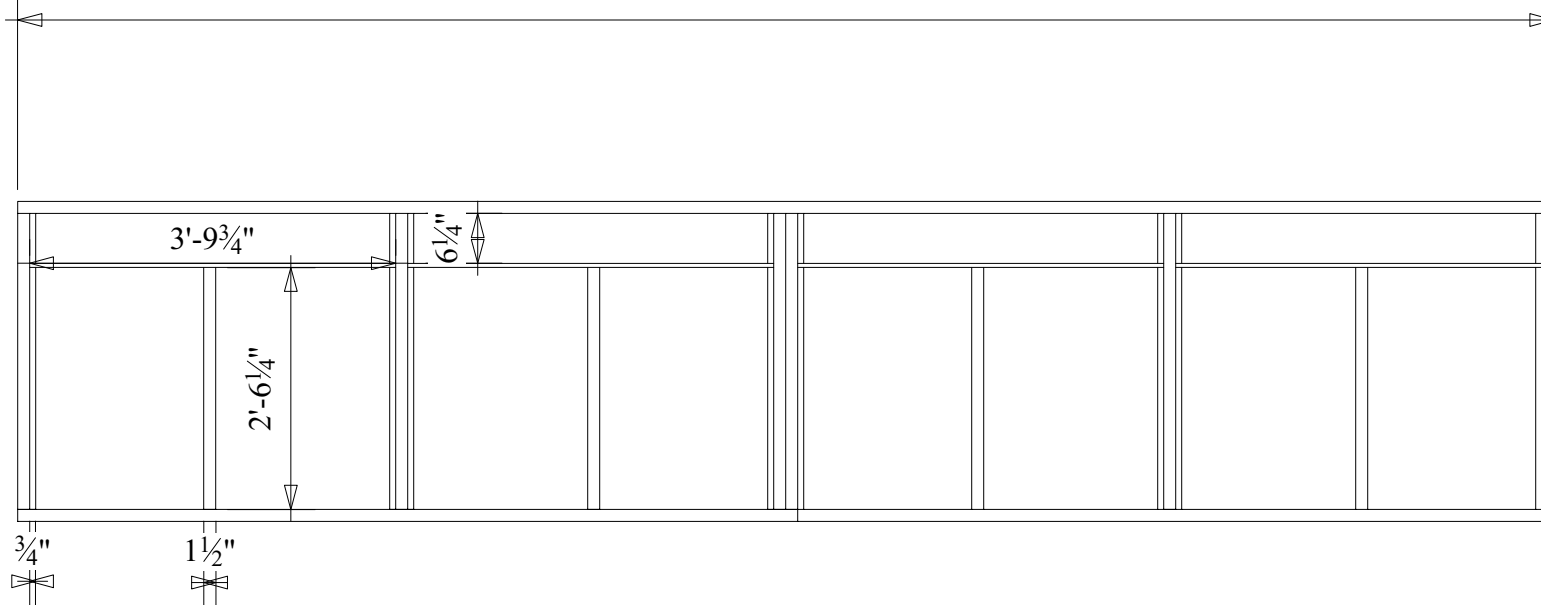

3 **Side**
Scale: 1/2" = 1'-0"

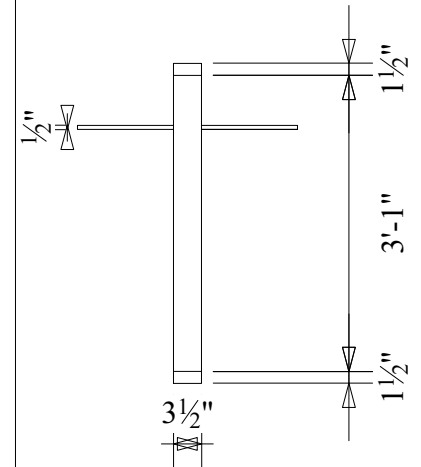

2 **Top**
Scale: 1/2" = 1'-0"

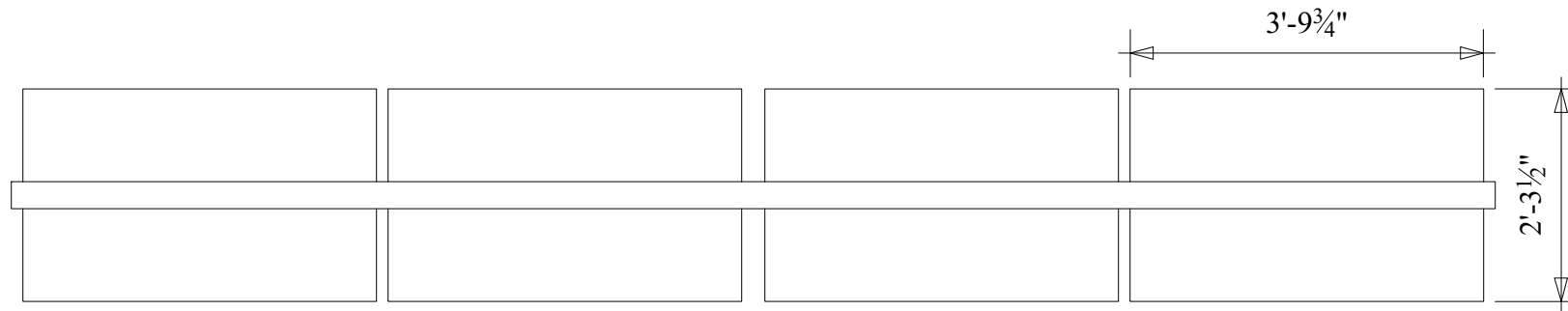
**General Notes**

Cut List:..

For this page only

2x4:

(2) 16'-0"

(6) 3'-1"

(4) 2'-6-1/4"

3/4"x3-1/2" Plywood:

(8) 2'-6 1/4"

(8) 0'-6-1/4"

1/2" Plywood:

(4) 2'-3-1/2"x3'-9-3/4"

Show Name

Catch Me If YouCan

Scale

1/2"=1'

Drawn By

Scott Bedell

Date

3/12/2019

Scene:

Bar-2

Object

Studs P1

Page Number

2

1 Front
Scale: 1/2" = 1'-0"

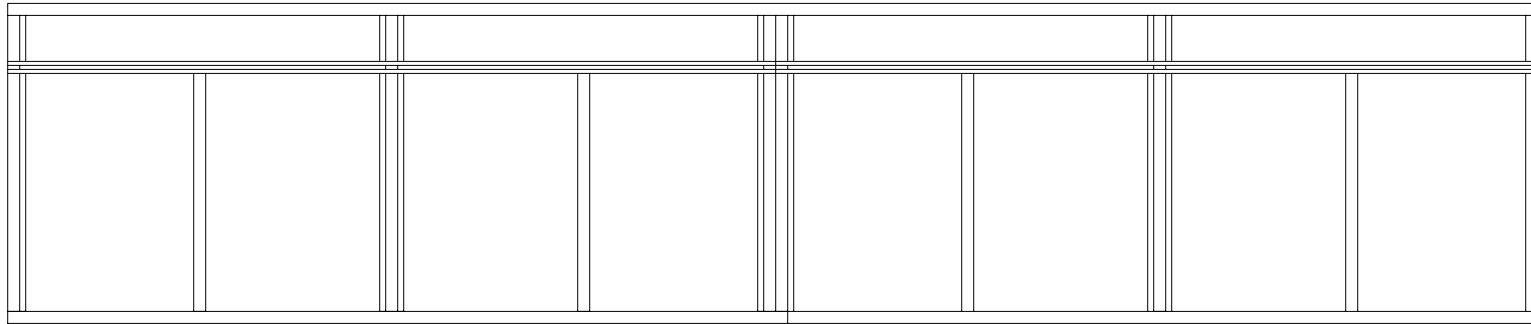

3 Side
Scale: 1/2" = 1'-0"

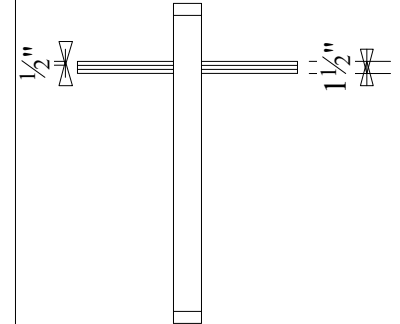

2 Top
Scale: 1/2" = 1'-0"

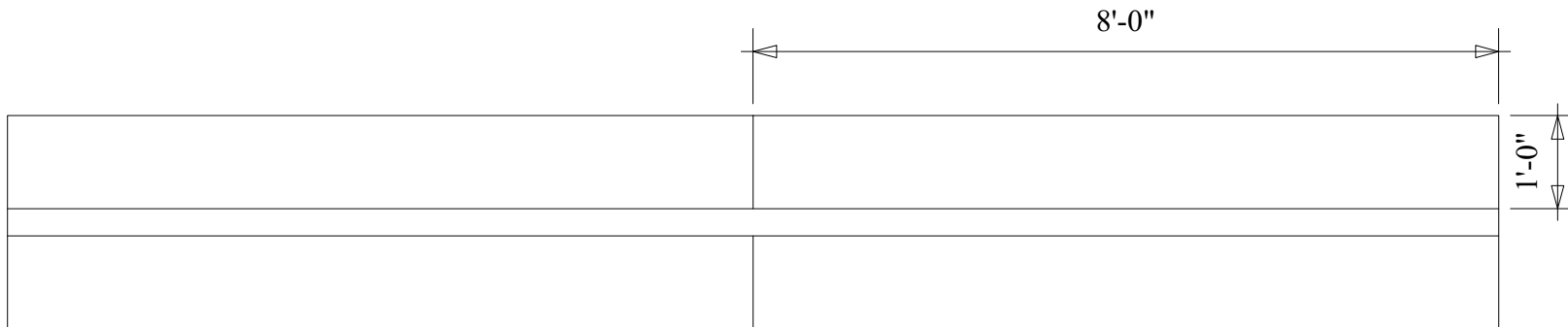

General Notes

Cut List: **For this page only**
1/2" Plywood:
(4) 1'-0"x8'-0"

Show Name Catch Me If YouCan		
Scale 1/2"=1'	Drawn By Scott Bedell	Date 3/12/2019
Scene: Bar-3	Object Studs P2	Page Number 3

1 Front
Scale: 1/2" = 1'-0"

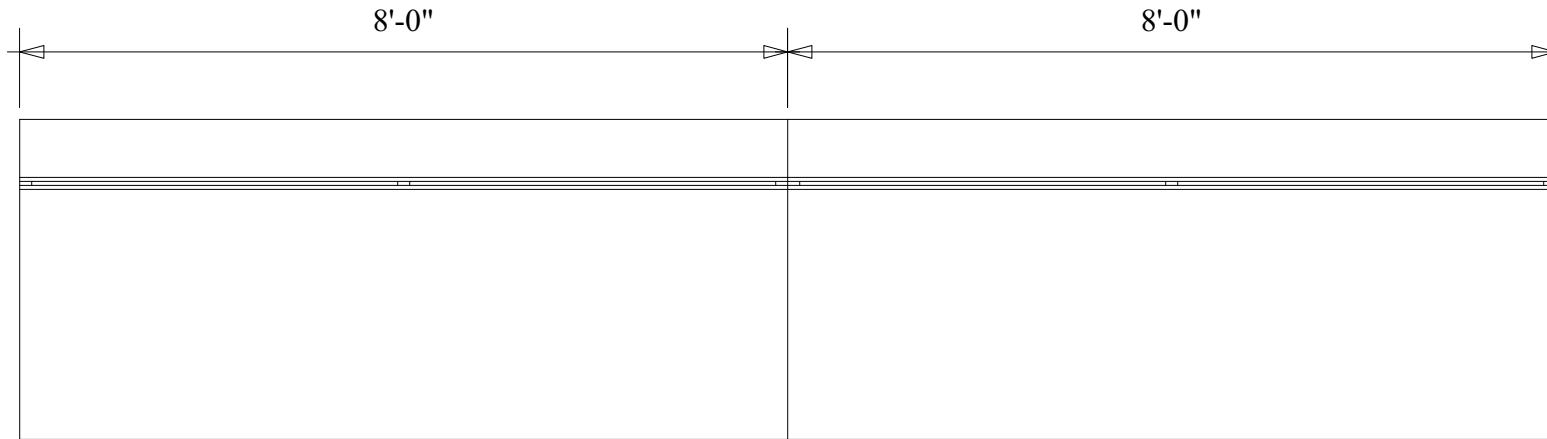

3 Side
Scale: 1/2" = 1'-0"

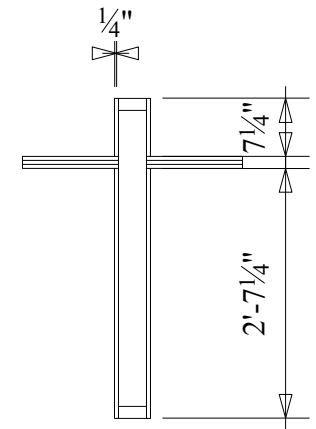

2 Top
Scale: 1/2" = 1'-0"

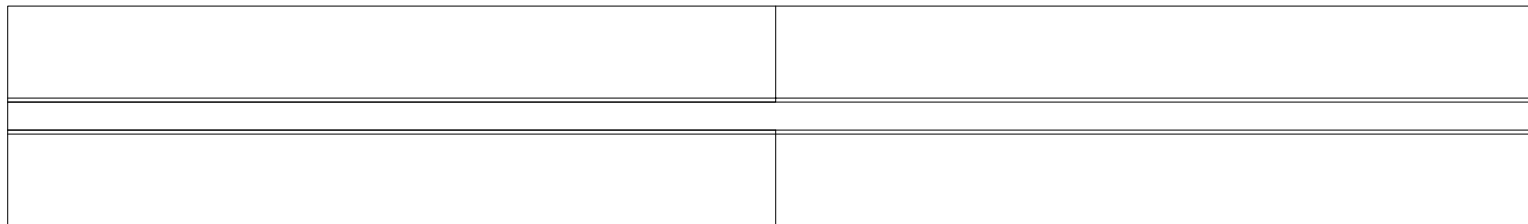

General Notes

Cut List: **For this page only**
Luan:
(4) 0'-7-1/4"x8'-0"
(4) 2'-7-1/4"x8'-0"

Show Name Catch Me If YouCan		
Scale 1/2"=1'	Drawn By Scott Bedell	Date 3/12/2019
Scene: Bar-4	Object Facing	Page Number 4