

1 Stringer A

General Notes

A. Every step will be 8-1/16" Rise Cut and 8-3/8" Run Cut unless otherwise marked

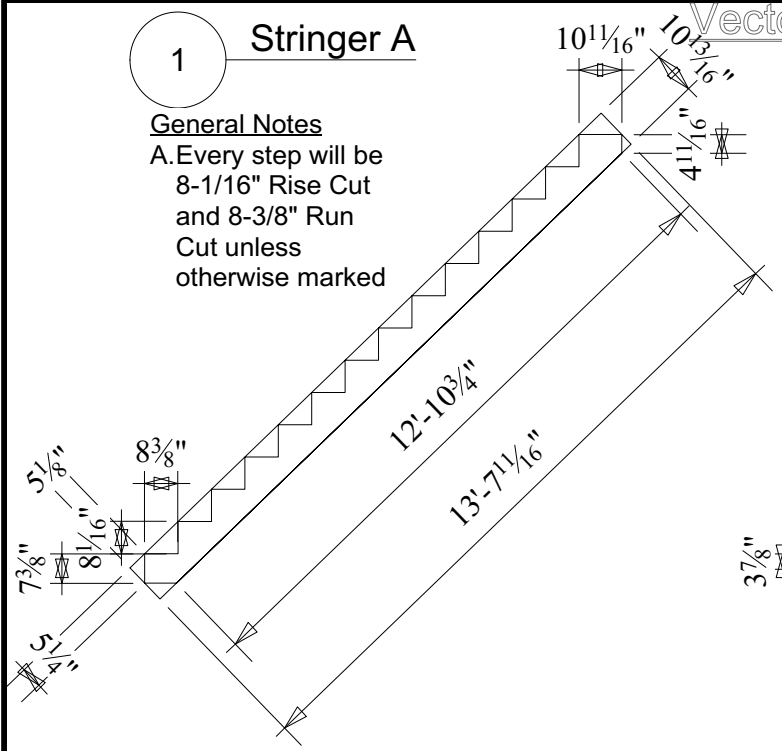

2 Stringer B

General Notes

A. For center stringer, make additional cuts to top and bottom as noted.

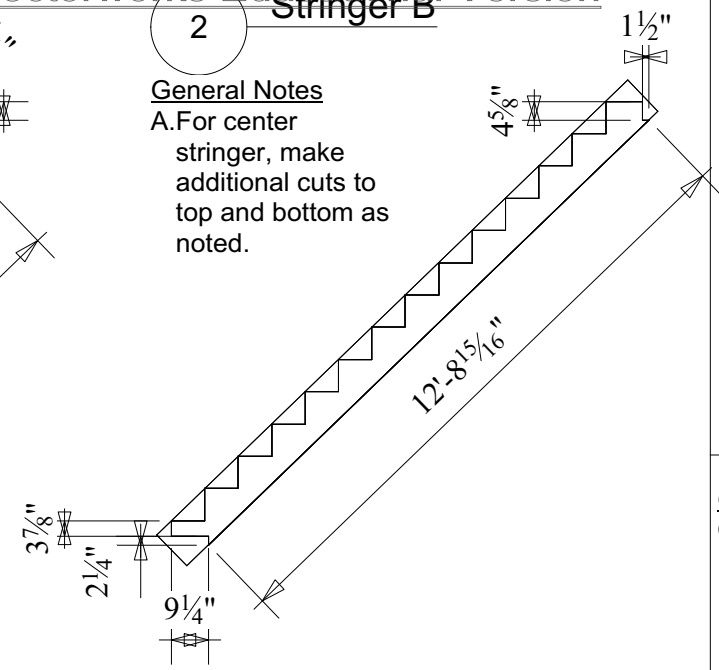

6 Iso

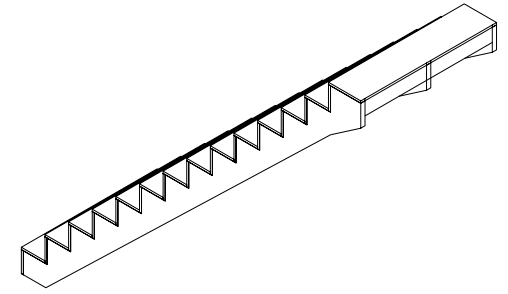

3 Front

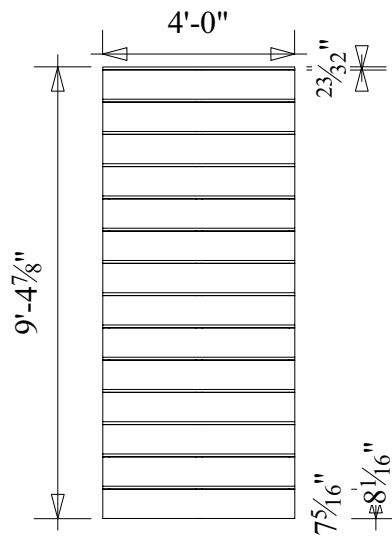

4 Side

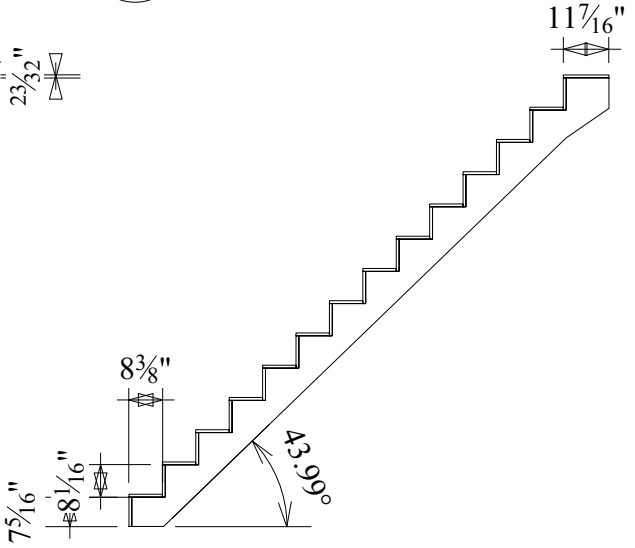

5 Back

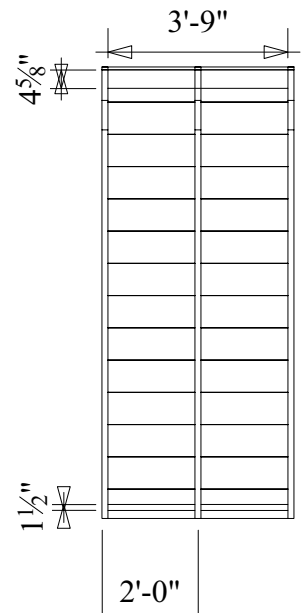

General Notes

Cut List. 23/32" Plywood: \*\*This project is spec for exact lowgrade plywood\*\*  
 (12) 10-13/16" x 8'-0" \*\*Lap these to create (3) 10-13/16" x 13'-7-11/16" Stringers  
 (1) 7-5/16" x 4'-0"  
 (1) 11-7/16" x 4'-0"  
 (13) 8-1/16" x 4'-0"  
 (13) 8-3/8" x 4'-0"  
 2x6 Lumber:  
 (1) 1.5"x4-5/8"x3'-9-1/8"  
 2x10 Lumber:  
 (1) 3'-9-1/8"

Instructions.

- Rough Cut Plywood for Stringers
- Lap, Glue, and Staple Rough Cuts to Create (3) Stringers
- Cut all (3) stringers as depicted by "Stringer A"
- Finish Cut (1) stringer as depicted by "Stringer B"
- Insert and 3" screw 2x6 and 2x10 boards
- Glue and staple all steps with 3" widecrown staples
- Attach caster plates to bottom 2x10 and drill holes for standard bolts on 2x6

Show Name Noises Off 2019		
Reference 1/4"=1'	Drawn By Scott Bedell	Date 09/04/19
CAD File Name Staircase C - Large Staircase		